

P/2015/00875

Received 10/06/15

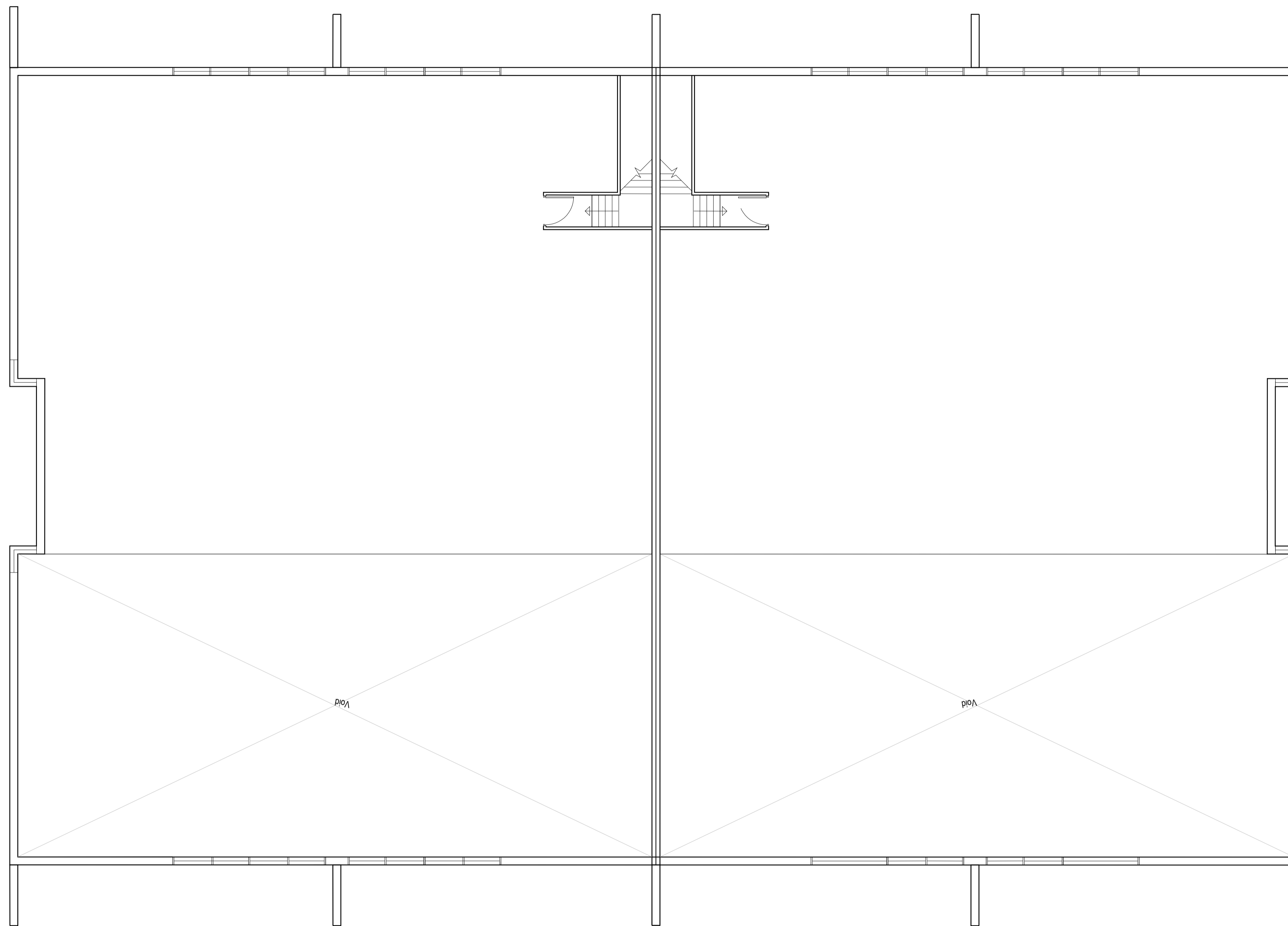

rev	details	by	date
P00	ISSUED FOR PLANNING	MC	05.06.2015

rev	details	by	date

Notes

1. Do not scale from drawing, use figured dimensions only.
2. All dimensions to be checked onsite.
3. This drawing to be read in conjunction with all other Gillespies drawings and specifications.

Ordnance information shown is reproduced from Ordnance Survey material with the permission of Ordnance Survey on behalf of the Controller of Her Majesty's Stationary Office. © Crown Copyright. Unauthorised reproduction infringes Crown Copyright and may lead to prosecution or civil proceedings. License No. 1000 17362

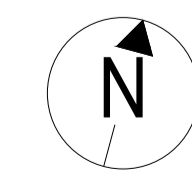

Engineers

Quantity surveyors

Other consultants

Project title
UTTOXETER-DOVE WAY

NAME: [blank]
Address 01: [blank]
Address 02: [blank]
P/N/F/K/A

NAME: [blank]
Address 01: [blank]
Address 02: [blank]
P/N/F/K/A

NAME: [blank]
Address 01: [blank]
Address 02: [blank]
P/N/F/K/A

Drawing title
**UNIT 5
FIRST FLOOR PLAN**

Drawing number
M5242-1-151

Drawing Status
PLANNING

Date: 05.06.15 Scale: 1:100 @ A1

Revision
P00

Drawn: MC Checked: MS

East Staffordshire Borough Council
The Maltsters
Wetmore Road
Burton upon Trent
DE14 1LS

GILLESPIES
Milton Chambers, 12 Healds Court, Leeds LS1 4LJ
P: 0113 247 0500 F: 0113 247 0600 E: design.team@gillespies.co.uk